

# Front LCD Orientation Instructions

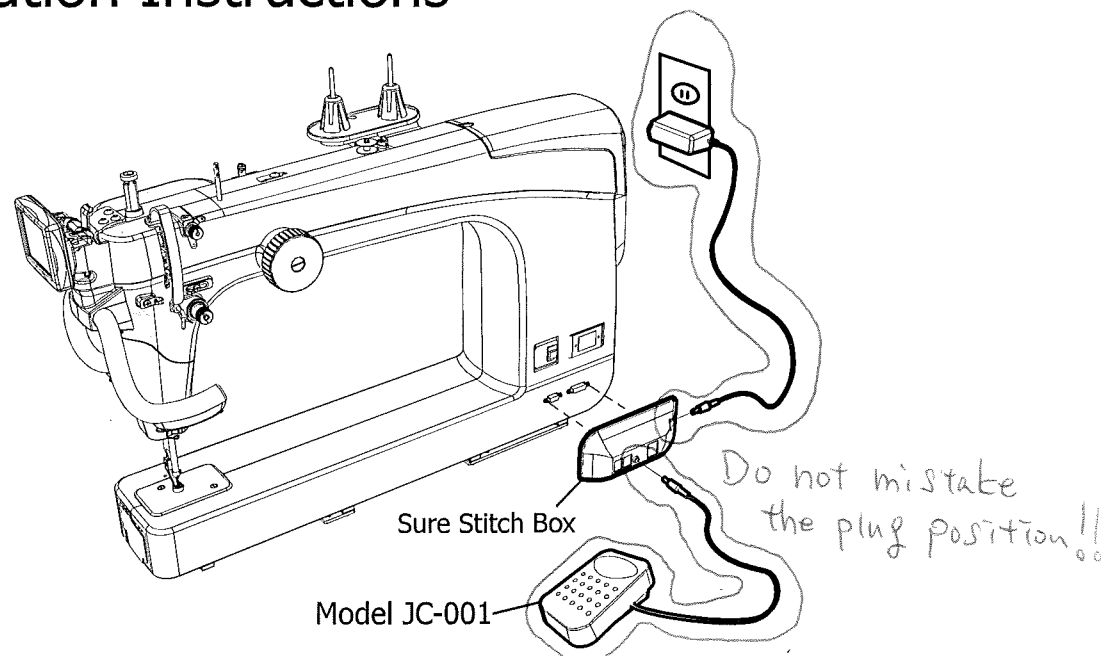
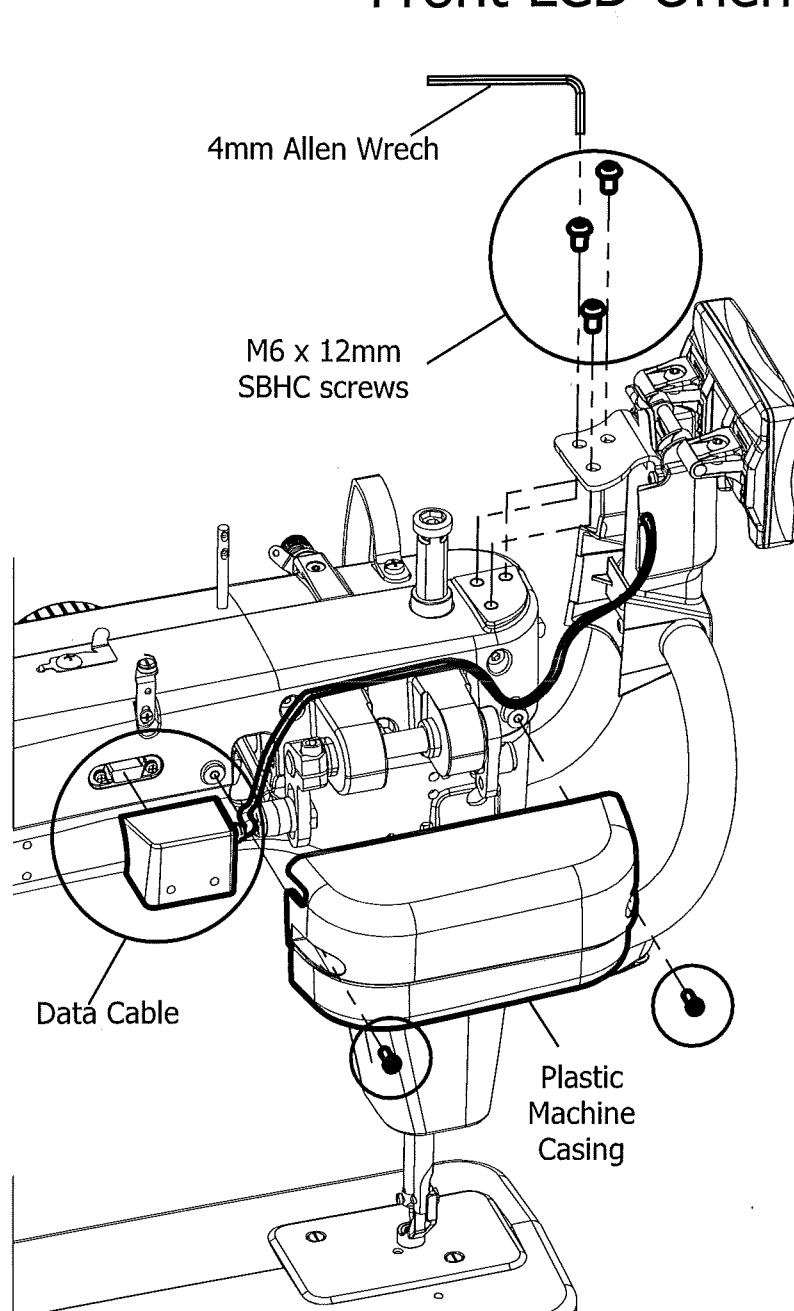

5. Install the LCD and Lighting Mount using the (3) M6 x 12mm SBHC screws and 4mm Allen Wrench. Be sure not to pinch the LCD Cable and that it falls in the groove provided.
6. Remove the (2) screws holding the plastic machine casing to the side of the machine.
7. Plug in the Data Cable into the left side of the machine.
8. Reinstall the plastic machine casing to the side of the machine. Be sure to cover the Data Cable without pinching it using the grooves provided.
9. Plug in the Sure Stitch Box to the back right corner of the machine. Plug the foot pedal into the connector on the front face of the Sure Stitch Box and the Power Supply into the back connector. Plug the other end of the Power Supply into a power outlet.